

**Surface-mounted outdoor station with
colour camera and call push button 1-gang**

1269 65/66/67

**Surface-mounted outdoor station with
colour camera and call push button 2/3-gang**

1270 65/66/67

GIRA

Table of contents

Device description	4
Functional scope of the colour camera	5
Selection of the installation site.....	6
Mounting	7
Start-up.....	8
Range of coverage of the colour camera	9
Setting range of coverage	10
Operation.....	12
Changing the label plates.....	13
Technical data.....	14
Acceptance of guarantee	15

Device description

The surface-mounted outdoor station with colour camera is a prefabricated unit and is part of the Gira door communication system.

The basic structure of a surface-mounted outdoor station is presented in the example of the surface-mounted outdoor station with colour camera and call push button 2/3-gang.

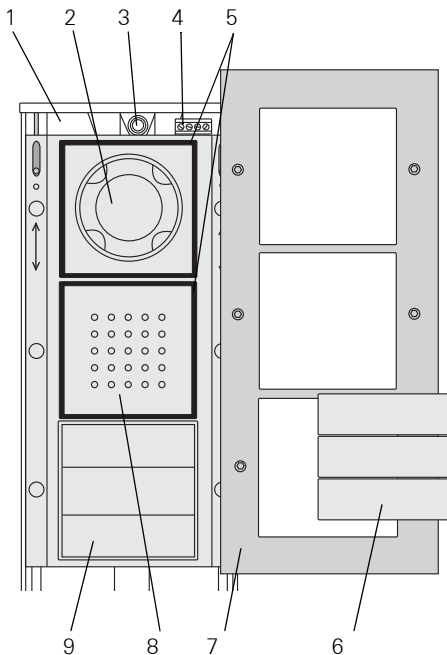

- | | |
|---------------------------|---------------------------|
| 1 Housing, bottom section | 6 Call push button covers |
| 2 Colour camera | 7 Housing, top section |
| 3 Cable inlet | 8 Speech cover |
| 4 Connection terminals | 9 Call push button 3-gang |
| 5 Sealing rings | |

The colour camera of the flush-mounted outdoor station has the following product features:

Automatic day/night switching

The camera switches from daytime operation (colour presentation) to night mode (black and white presentation) and back again at an ambient brightness of 1 lux. Good display results are achieved due to the high-degree of light sensitivity in night mode, even with poor lighting conditions (up to 0.1 lux).

The integrated white LEDs ensure an even field of view illumination in night mode.

Large range of coverage

The colour camera can be swivelled manually by 20° horizontally and vertically during start-up. A very large field of view in the door entry area results in conjunction with the 100° range of coverage of the camera.

Camera heating

The integrated temperature-dependent camera heating prevents condensation from forming on the camera cover due to changing weather conditions and thus provides a clear view.

Camera cover

The splash water-resistant cover made of impact-resistant plastic can be easily replaced if damaged, e.g. through vandalism.

The selection of the installation site and good illumination are critical for good picture quality.

No backlighting

Do not point the camera toward strong background lighting, such as streetlamps or yard illumination.
Prevent strong sunlight from hitting the lens.

Picture background

Avoid pointing the camera toward extremely light picture backgrounds and backgrounds with stark contrasts.

Illumination

LEDs integrated in the camera provide even field of view illumination in the darkness.



Black and white mode in poor lighting conditions

In poor lighting conditions (< 1 lux) or with the field of view illumination switched on, the colour camera provides black and white pictures only.

If the entry area is equipped with additional illumination, ensure that the light source does not shine directly into the camera from the front. The best installation site of an external light source is above the colour camera.

Installation height

The recommended installation height of the colour camera is 1.50 m.

At this installation height, people with an average height of 1.80 m are presented optimally.

The minimum installation height is 1.20 m.



Attention

Installation and mounting of electrical devices may only be carried out by a qualified electrician.



Movable PCB

The PCB can be pushed downward for mounting and for connection of the bus line.

1. Select the installation site. The cable duct leading into the bottom section of the housing is used for line guidance. The installation height of the outdoor station can be varied via the line outlet in this way.
2. Mark the mounting holes using the hole template (part of the packaging).
3. Drill the holes (6 mm) and insert the accompanying plugs.
4. Guide the stripped bus line with approx. 5 mm of insulation into the bottom section of the housing.
5. Mount the bottom section of the housing to the wall with the accompanying screws.
Push the PCB downward to screw in the upper mounting screws.
6. Connect the 2-wire bus to the bus terminals.

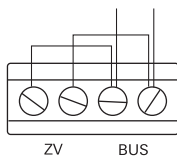

Jumpers between BUS and ZV

The wire jumpers between BUS and ZV are required for operation of the colour camera. Thus the illumination of the call buttons at the outdoor station cannot be switched off.

If an external supply is connected to the ZV terminals, the jumpers between ZV and BUS must be removed.

7. Push the PCB into the upper position.
8. Set the camera lens in the desired direction (see "Setting range of coverage", Page 10).
9. Remove the protective film on the lens.
10. Attach the camera cover.
11. Ensure proper seating of the speech cover and colour camera sealing rings.
12. Set the upper section of the housing in place, press on it firmly and screw in the Torx screws.



Measures for theft protection

Instead of using Torx screws, you can also use the optional Tri-Wing screws to secure the top section of the frame.

Start-up

Once you have installed all of the devices (outdoor and home stations, video control unit etc.), you can start up the door communication system.

Start-up is described in the system manual included with the video control unit.

Range of coverage of the colour camera

The CCD sensor element of the colour camera has an angular coverage of 100° .

If this angular coverage is not sufficient for your installation scenario, you can swivel the area to be captured by 20° in all directions.

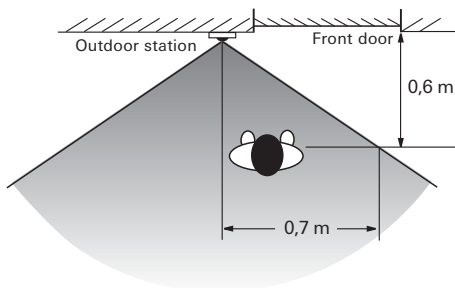

Range of coverage of the camera in non-swivelled state.

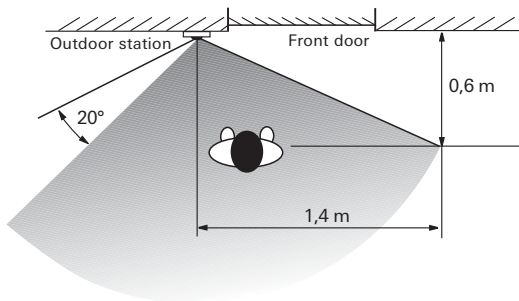

Range of coverage of the camera when it is swivelled by 20° .



Protective lens film

The protective film on the lens of the colour camera protects the sensitive optics from scratches and soiling. Leave this film on the lens as long as possible and avoid touching the lens directly after the protective film has been removed.

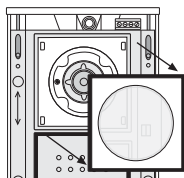

1. Remove (with the housing frame open) the cover from the colour camera.

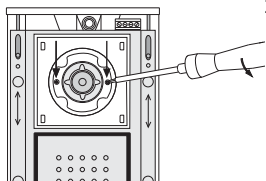

2. Slightly loosen both Torx screws to the left and right of the camera lens.



Do not screw the screws out completely!

When adjusting the lens carrier, it is sufficient to slightly loosen the screws.

Do **not** completely unscrew the screws from their brackets.

3. Set the camera lens in the desired direction.

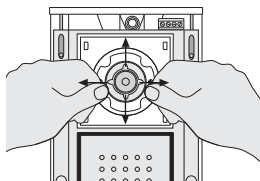

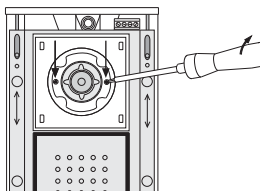

4. At the TFT display of the connected home station, check whether the set angle of the camera lens is adjusted properly and whether the view of a person in front of the door is optimal.
5. Lock the lens carrier by tightening both Torx screws again.
6. Remove the protective film on the lens.
7. Reattach the camera cover.
8. Set the upper section of the housing in place, press on it firmly and screw in the Torx screws.

Volume setting

The volume can be set separately at each outdoor station.
The volume setting must be made by two people.



1. Start programming mode at the **control unit** by pressing the "Systemprogr." button for 3 seconds until the yellow LED next to the button starts flashing.



2. Briefly press a previously assigned call push button at the **outdoor station**.



3. The second person accepts the door call at the **home station** (via receiver or speech button) and starts speaking.



4. Briefly press the call push button at the **outdoor station** again.



- ✓ The volume changes when the button is pressed during the voice connection.

There are five volume levels in total.

The next-highest volume is set with each button press. When the loudest volume level is reached, the next button press sets the quietest volume level.



5. End the voice connection.

The most recently set volume level is saved in the outdoor station.



6. Exit programming mode at the **control unit** by briefly pressing the "Systemprogr." button.

Initiating a call (ringing)



Press the call push button to trigger a call tone at the assigned home station. The button press is confirmed by an additional acknowledgement tone.

Switching light on (in conjunction with a switching actuator)



Press the call push button to switch on light or another device via an assigned switching actuator. The button press is confirmed by an additional acknowledgement tone.

Changing the label plates

To change the label plates, the call push button cover can simply be lifted up.

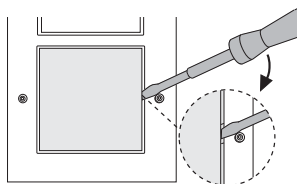

1. Carefully lift the call push button cover, e.g. with a screwdriver.
2. Change the label plate.
3. Replace the call push button cover and press on it firmly.

Suitable label plates can be obtained with the optional Gira labelling software and the appropriate Gira labelling sheets.

Technical data

Power supply:	2 cameras via video control unit 3rd and 4th camera via external additional supply (24 V DC)
Connections of camera insert:	2 system bus plug strips 1 video plug strip 1 plug strip connection for future applications
Image capture element:	CCD sensor 1/3"
Wide-angle objective:	150° aperture angle
Visible range of coverage:	100° angular coverage of the camera
Detectable area:	140° (with 20° swivelling)
Colour system:	PAL
Pixels:	500 (H) x 582 (V)
Horizontal resolution:	380 TV lines
Switching threshold colour to B/W operation:	1 lux
Light sensitivity in B/W operation:	0.1 lux
Electronic shutter close time:	up to 1/100000 s
Camera inst. height - min. height:	1.20 m
Recommended installation height:	1.50 m
Temperature range:	-20 °C to +50 °C

Acceptance of guarantee

The warranty is provided in accordance with statutory requirements via the specialist trade.

Please submit or send faulty devices postage paid together with an error description to your responsible salesperson (specialist trade/installation company/electrical specialist trade).

They will forward the devices to the Gira Service Center.

Gira
Giersiepen GmbH & Co. KG
Elektro-Installations-
Systeme
Postfach 1220
42461 Radevormwald
Deutschland
Tel +49 (0) 21 95 / 602 - 0
Fax +49 (0) 21 95 / 602 - 191
www.gira.de
info@gira.de

10 41 01 82 22/11

GIRA